

ORDINANCE NO. 40

AN ORDINANCE CHANGING BOUNDARIES AND DESIGNATING WARDS IN THE TOWN OF ENNIS, PROVIDING FOR ELECTION OF ALDERMEN FROM SAID CHANGED WARDS IN THE YEAR 1971.

Be it ordained by the Town Council of the Town of Ennis, Montana

1. That pursuant to authority contained in section 11-708 RCM 1947, as amended, the boundaries and numbers of the wards within the Town of Ennis shall be changed to the following:

(a) WARD I.: All that portion of the Town of Ennis north of the center of Ennis Street from the east boundary of the Town of Ennis to the west boundary of the Town of Ennis.

(b) WARD II.: All that portion of the Town of Ennis south of the center of Ennis Street from the east boundary of the Town of Ennis to the west boundary of the Town of Ennis.

2. This ordinance shall be in full force and effect commencing the first Monday in May, 1971, and all elections of aldermen during the elections for the year 1971 shall be in accordance with the foregoing division of wards.

PASSED by the Council and APPROVED by the Mayor this 9th day of June 1969.

Harold Wells
MAYOR

ATTEST:

Lucia M. Taylor
TOWN CLERK

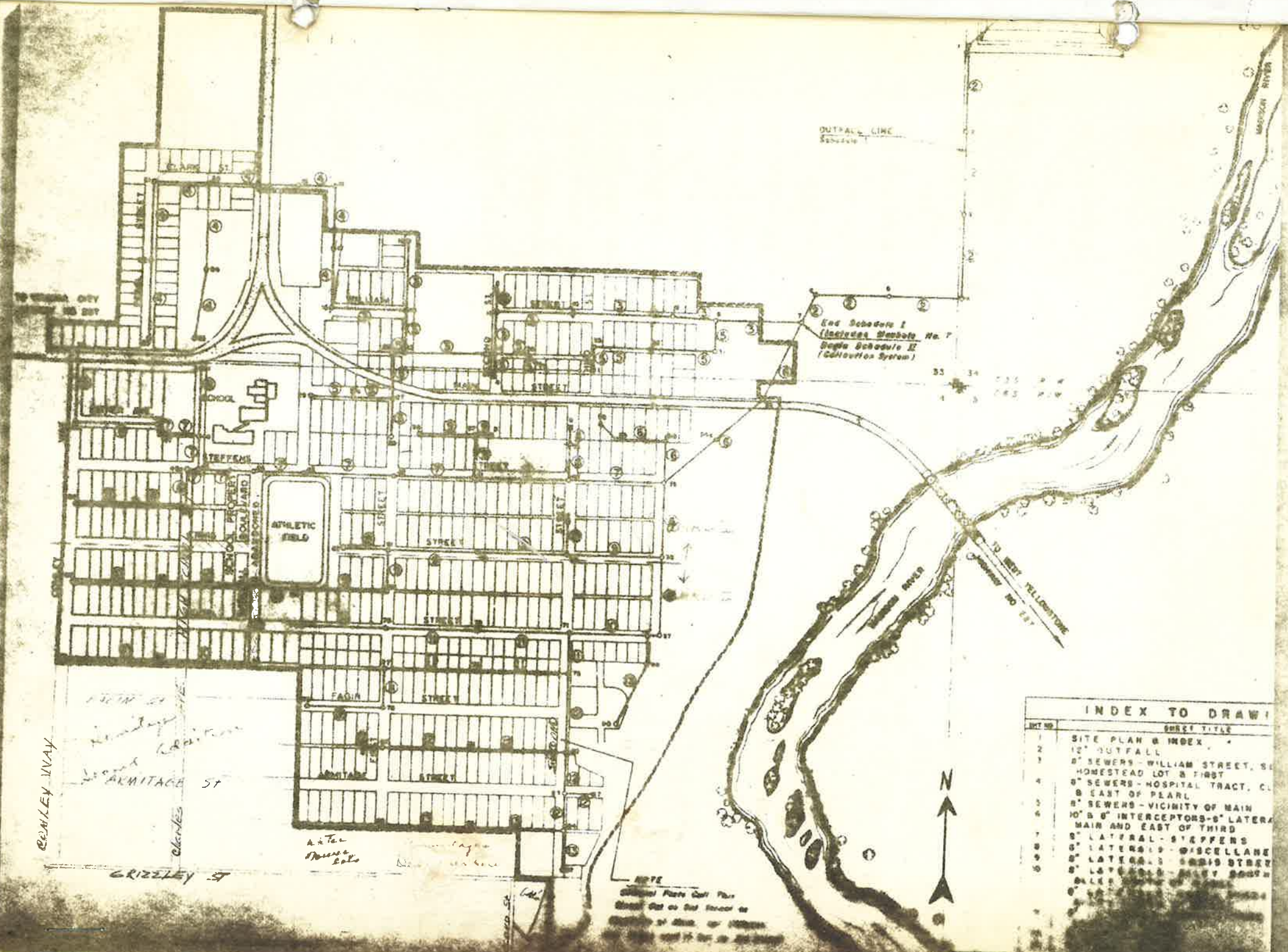

INDEX TO DRAWING

NO.	SHEET TITLE
1	SITE PLAN & INDEX
2	12" OUTFALL
3	8" SEWERS - WILLIAM STREET, S. & HOMESTEAD LOT & FIRST
4	8" SEWERS - HOSPITAL TRACT, CL. & EAST OF PEARL
5	8" SEWERS - VICINITY OF MAIN
6	10" & 8" INTERCEPTORS - 8" LATERALS MAIN AND EAST OF THIRD
7	8" LATERAL - STEFFENS
8	8" LATERALS - MISCELLANEOUS
9	8" LATERALS - HERITAGE STREET
10	8" LATERALS - FAIR STREET SOUTH